

PRINCES SQUARE

BY MI

UNIT 27-28 LEASING BROCHURE

A versatile space, the mirror boutique offers a large open frontage with floor space to accommodate a variety of fixtures and displays surrounded by wall-mounted shelving.

Located in a prime position next to premium neighbours and the main escalator down to lower mall floors. This unit also benefits from a large back of house area with toilet, kitchen area and ample storage space.

RECENT LETTINGS:

The Club House | All Saints | & Other Stories
| Bloom | The Whiskey Shop

SHOP | DINE | MEET

92 yards from
Buchanan Street





DETAILS

| | SQ.FT | SQ.M |
|-----------------|-------|--------|
| Internal | 1,338 | 124.30 |
| Total | 1,338 | 124.30 |

Rent

- £90,000 per annum

Rates Payable

- £16,808

Service Charge

- £25,031

Insurance

- £1,144

Marketing

- £1,314

EPC

- Available upon request.

FLOORPLAN

Ground Floor

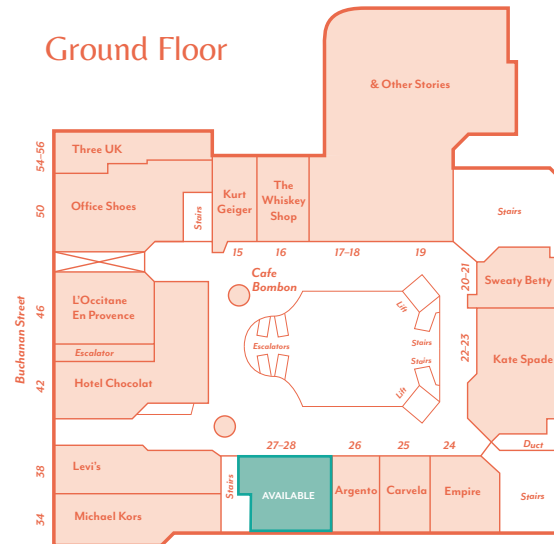



CONTACT

Rakesh Joshi

T +44 (0)7741 385 322

E rjoshi@lcpproperties.co.uk

Alex Williams

M +44 (0)7741 951843

E awilliams@lcpproperties.co.uk

Stuart Moncur

M +44 (0)7887 795 506

E stuart.moncur@savills.com

Charlie Hall

M +44 (0)7807 999 693

E charlie.hall@savills.com

James Godfrey

M +44 (0)7768 190114

E james@culverwell.co.uk

LCP
part of M Core

**01384
400123**

searchlcp.co.uk



Culverwell

0131 226 6611
www.culverwell.co.uk

@princessquare

@princessquare

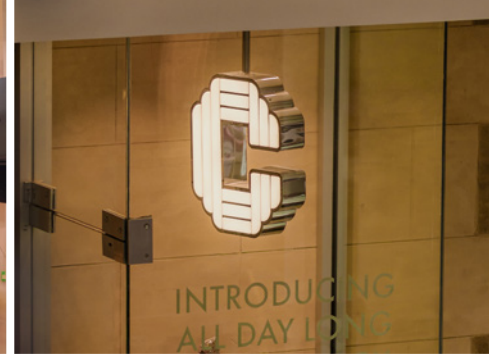

Savills and Culverwell for themselves and for the vendors or lessors of this property for whom they act, give notice that: (i) these particulars are a general outline only, for the guidance of prospective purchasers or tenants, and do not constitute the whole or any part of any offer or contract; (ii) Savills and Culverwell cannot guarantee the accuracy of any description, dimensions, references to condition, necessary permissions for use and occupation and other details contained herein and prospective purchasers or tenants must not rely on them as statements of fact or representations and must satisfy themselves as to their accuracy; (iii) no employee of Savills and Culverwell has any authority to make or give any representation or warranty or enter into any contract whatever in relation to this property; (iv) rents quoted in these particulars may be subject to VAT in addition; and (v) Savills and Culverwell will not be liable, in negligence or otherwise, for any loss arising from the use of these particulars. Consumer Protection from Unfair Trading Regulations 2008 and Business Protection from Misleading Marketing Regulations 2008: Every reasonable effort has been made by Savills and Culverwell to ensure accuracy and to check the facts contained in these particulars are complete. Interested parties are strongly advised to take appropriate steps to verify by independent inspection or enquiry all information for themselves and to take appropriate professional advice. Designed & produced by Maguire.

princessquare.co.uk

NOVEMBER 2024

34732 NOV 24